

API RING JOINT GASKETS

RX Series

For Up From 2,000 to 5,000 PSI



HARDNESS CHART

RING GASKET MATERIAL	MAXIMUM HARDNESS		IDENTIFICATION MARK
	BRINELL	ROCKWELL B	
Low Carbon Steel	120	68	S
316 SS	160	83	S 316

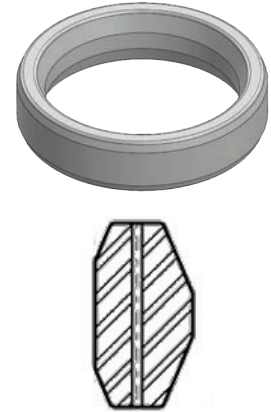

Cross Section

ORDERING INFO AND DIMENSIONS

API 6A Ring Joint Gaskets

RING GROOVE SIZE	FLANGE SIZE	PRESSURE RATING	PART #	
			LOW CARBON STEEL	316 SS
RX-23	2 1/16"	2,000	RG511023	RG512023
RX-24	2 1/16"	3,000/5,000	RG511024	RG512024
RX-26	2 9/16"	2,000	RG511026	RG512026
RX-27	2 9/16"	3,000/5,000	RG511027	RG512027
RX-31	3 1/8"	2,000/3,000	RG511031	RG512031
RX-35	3 1/8"	5,000	RG511035	RG512035
RX-37	4 1/16"	2,000/3,000	RG511037	RG512037
RX-39	4 1/16"	5,000	RG511039	RG512039
RX-41	5 1/8"	2,000/3,000	RG511041	RG512041
RX-45	7 1/16"	2,000/3,000	RG511045	RG512045
RX-45/46*	7 1/16"	2,000/3,000 to 5,000	RG511456	RG512456
RX-46	7 1/16"	5,000	RG511046	RG512046
RX-49	9"	2,000/3,000	RG511049	RG512049
RX-50	9"	5,000	RG511050	RG512050
RX-53	11"	2,000/3,000	RG511053	RG512053
RX-54	11"	5,000	RG511054	RG512054
RX-57	13 5/8"	2,000/3,000	RG511057	RG512057
RX-73	21 1/4"	2,000	RG511073	RG512073
RX-74	20 3/4"	3,000	RG511074	RG512074

* Non API transition Gasket.
ASME B16.5 RX Gaskets available upon request.