

API RING JOINT GASKETS

BX Series

For Up to 20,000 PSI



HARDNESS CHART

RING GASKET MATERIAL	MAXIMUM HARDNESS		IDENTIFICATION MARK
	BRINELL	ROCKWELL B	
Low Carbon Steel	120	68	S
316 SS	160	83	S 316

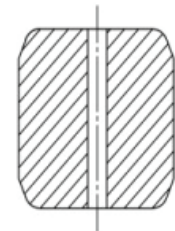

Cross Section

ORDERING INFO AND DIMENSIONS

API 6A/ASME B16.20 Ring Joint Gaskets

RING GROOVE SIZE	FLANGE SIZE	PRESSURE RATING	PART #	
			LOW CARBON STEEL	316 SS
BX-150*	1 11/16"	10,000/15,000	RG801150	RG802150
BX-151	1 13/16"	10,000/15,000/20,000	RG801151	RG802151
BX-152	2 1/16"	10,000/15,000/20,000	RG801152	RG802152
BX-153	2 9/16"	10,000/15,000/20,000	RG801153	RG802153
BX-154	3 1/16"	10,000/15,000/20,000	RG801154	RG802154
BX-155	4 1/16"	10,000/15,000/20,000	RG801155	RG802155
BX-156	7 1/16"	10,000/15,000/20,000	RG801156	RG802156
BX-157	9"	10,000/15,000/20,000	RG801157	RG802157
BX-158	11"	10,000/15,000/20,000	RG801158	RG802158
BX-159	13 5/8"	10,000/15,000/20,000	RG801159	RG802159
BX-160	13 5/8"	5,000	RG801160	RG802160
BX-162	16 3/4"	5,000/10,000	RG801162	RG802162
BX-163	18 3/4"	5,000	RG801163	RG802163
BX-164	18 3/4"	10,000/15,000	RG801164	RG802164
BX-165	21 1/4"	5,000	RG801165	RG802165
BX-169**	5 1/8"	10,000/15,000	RG801169	RG802169
BX-171	8 9/16"	10,000/15,000	RG801171	RG802171

*BX-150 pressure rating as per ASME B16.20 only.

**BX-169 15,000 as per API 6A only.